

Installation Instructions

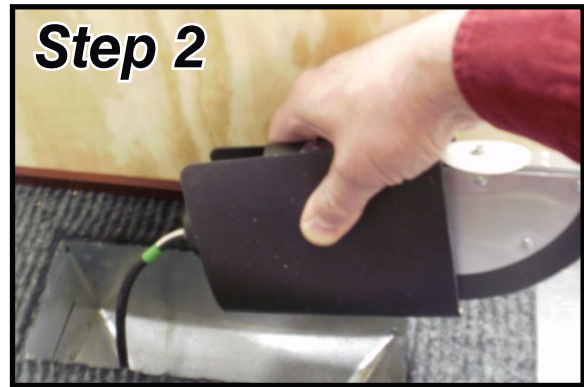

Installation Instructions

1. Run tubing from register to panel
2. Connect tubing to damper.
3. Fold blade first, then fold magnet around the blade
4. Insert damper through the boot-tubed end first. Ensure the blade is past any sheet metal screws holding the boot to the branch run and release blade.
5. Settle the magnet against the inside of the duct. Ensure magnet is adhered completely to inside of duct.
6. Cycle the blade several times to ensure clear movement and good magnet seating.